

(09T-04T) VI 080TK9

REV	DESCRIPTION
0	NEW RELEASE

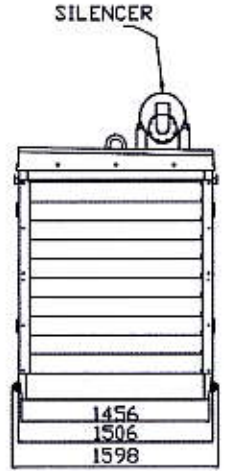

VIEW FROM ALTERNATOR SIDE

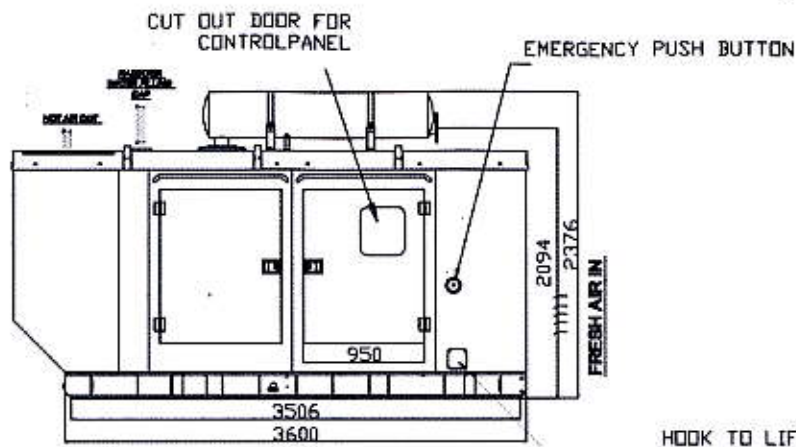

VIEW FROM FRONT

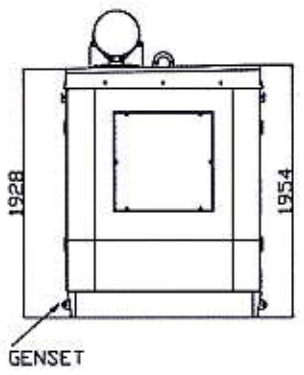

VIEW FROM GEAR SIDE

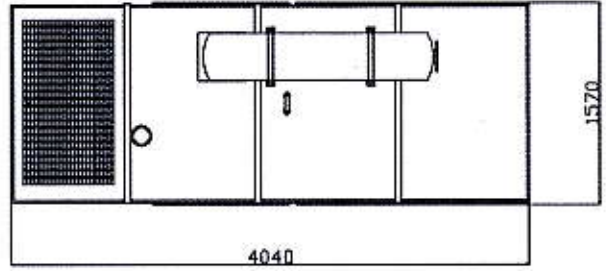
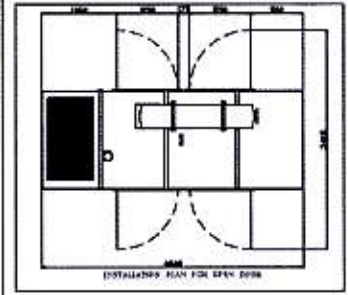

VIEW FROM TOP

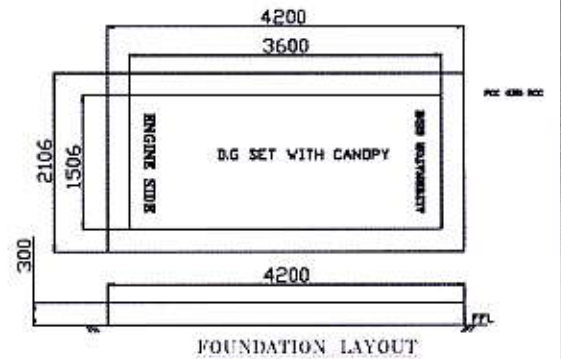

- NOTES:
1. FUEL TANK CAPACITY-300 LITRES
 2. HEIGHT OF FOUNDATION ABOVE FFL CAN BE MODIFIED DEPENDING UPON WATER STAGNATION.
 3. DEPTH BELOW FFL DEPENDS UPON THE SOIL CONDITION AT SITE.
 4. APPROX DEPTH BELOW FFL-500mm
 5. PCC OR RCC SHALL BE BASED ON THE SOIL CONDITION.
 6. HEIGHT OF CANOPY- 2376mm

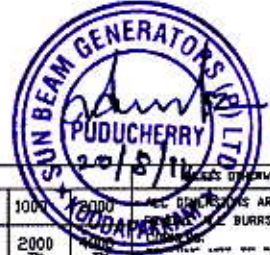

IF IN DOUBT ASK

PRINTS OF PREVIOUS REVISION NO. SHOULD BE SCRAPPED

OVER	UNSPECIFIED TOLERANCES							
	0.5	3	6	30	120	400	1000	2000
UPTO	3	6	30	120	400	1000	2000	2000
-VERY COARSE	-	30/0	30/0	120/0	400/0	1000/0	2000/0	2000/0

UNSPECIFIED FILLET RADII TO BE 3.0

UNLESS OTHERWISE SPECIFIED	
ALL DIMENSIONS ARE IN mm.	
ALL DIMENSIONS ARE TO BE BURRS AND SHARP	

CAB DRG FILE-		
MATERIAL - AS PER DRG	HEAT TREATMENT -	WEIGHT (kg) - AS PER DRG
DRG NO.	PAGES	TITLE

SUNBEAM Generators Pvt. Ltd.
PONDICHERRY

DRAWING NO. SBG/GA-FND/140-160 KVA